

Waterproofing Basement Walls

WATERPROOF MEMBRANE

PACKAGING



MIXING



APPLICATION



SUBSTRATES

CONCRETE
BRICK
BLOCK
CEMENT RENDER

MATERIALS:

Waterbased LIQUID FLASH 2 PACK is available from Construction Chemicals.

SURFACE PREPARATION:

All surfaces must be clean and sound, free of grease, dust, coatings and other contaminants. New concrete must have cured for 28 days or more.

WORKMANSHIP:

Apply products in accordance with the manufacturers written instructions and good trade practice.

APPLICATION:

At junctions in building surfaces and cracks or cold joints, apply bond breaker (Neutral Cure Silicone or 50mm BOND BREAKER tape) and reinforce with a 140mm REOMAT over the junction.

Apply two coats of 1.5mm thick/coat and allow 2-3 hours between coats.

Protect the membrane from back fill with polythene film (200um) and building board.

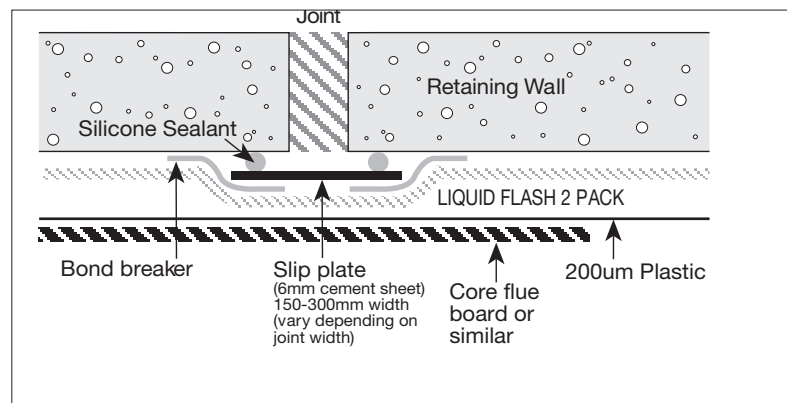
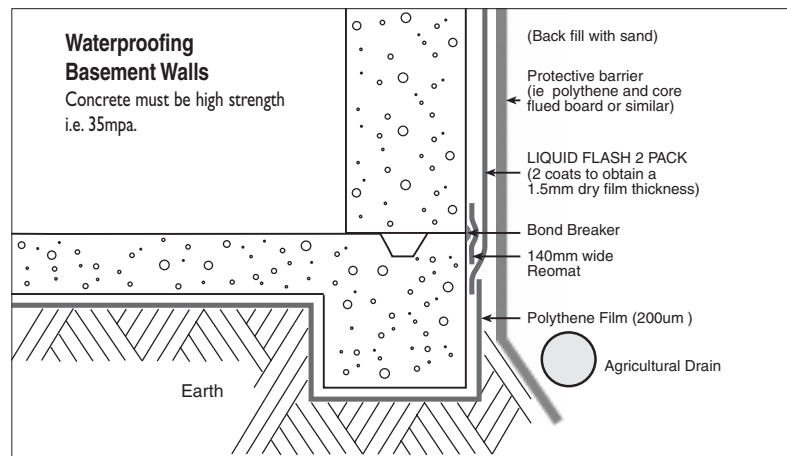

**CONSTRUCTION
CHEMICALS**

- **ADELAIDE** 135 CORMACK RD (Cnr Davis St) WINGFIELD 5013 PH: (08) 8243 7888 FAX: (08) 8243 7800
- **BRISBANE** 45 COULSON ST WACOL 4076 PH: (07) 3271 2944 FAX: (07) 3271 3892
- **MELBOURNE** 11 GABRIELLE CT BAYSWATER NORTH 3153 PH: (03) 9761 4711 FAX: (03) 9761 4748
- **PERTH** 11 COLLIE ST WELSHPOOL 6106 PH: (08) 9356 9999 FAX: (08) 9356 9955
- **SYDNEY** 31-33 NEWTON RD WETHERILL PARK 2164 PH: (02) 9756 3533 FAX: (02) 9756 3534
- **AUCKLAND** 16 CARPENTER RD EAST TAMAKI PH: (09) 273 5444 FAX: 0800 266 236
- **KUALA LUMPUR** LOT 2 JALAN KECAP1 33/2 ELITE INDUSTRIAL ESTATE OFF JALAN BUKIT KEMUNING 40000 SHAB ALAM PH: (603) 5122 2522 FAX: (603) 5122 2526

www.constructionchemicals.com.au

"The information contained in this technical publication is based on our current knowledge and experience and is provided as a guide only. In view of the many factors that may affect application it is the users sole responsibility to ensure suitability for a specific purpose."